

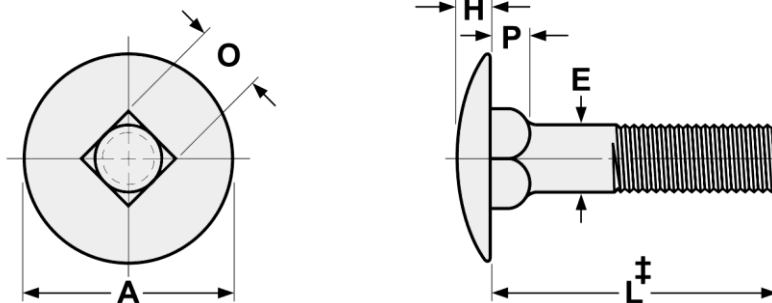

Cordova Bolt, Inc.

Step Bolts Product Information

1.0 Dimensions: As per ASME B18.5



Nominal Size or Basic Bolt Diameter	E		A		H		O		AC	P		S	Q	R
	Body Diameter		Head Diameter		Head Height		Square Width		Square Across Corners	Square Depth		Square Corner Height	Corner Radius on Square	Fillet Radius
	Max	Min	Max	Min	Max	Min	Max	Min	Min	Max	Min	Min	Max	Max
No. 10	0.199	0.3182	0.656	0.625	0.114	0.094	0.199	0.185	0.236	0.125	0.094	0.069	0.031	0.031
1/4	0.260	0.237	0.844	0.813	0.145	0.125	0.260	0.245	0.321	0.156	0.125	0.087	0.031	0.031
5/16	0.324	0.298	1.031	1.000	0.176	0.156	0.324	0.307	0.408	0.187	0.156	0.105	0.031	0.031
3/8	0.388	0.360	1.219	1.188	0.208	0.188	0.388	0.368	0.481	0.219	0.188	0.131	0.047	0.031
7/16	0.452	0.421	1.406	1.375	0.239	0.219	0.452	0.431	0.571	0.250	0.219	0.149	0.047	0.031
1/2	0.515	0.483	1.594	1.563	0.270	0.250	0.515	0.492	0.657	0.281	0.250	0.168	0.047	0.031

2.0 Mechanical Properties: A449

Size	Tensile KSI	Yield KSI	Elong. % min	RA % min
1/4-1	120 min	92 min	14	35
1-1/8 - 1-1/2	105 min	81 min	14	35
1-5/8 - 3	90 min	58 min	14	35

Disclaimer: The presented data is based off various industry standards. Cordova Bolt, Inc. strives to present up to date, accurate data. However Cordova Bolt, Inc. cannot be held liable for any errors or discrepancies within the presented information



Cordova Bolt, Inc.

5601 Dolly Avenue Buena Park CA 90621
(714) 739-7500 - (714) 994-2661-fax
www.cordovabolt.com