



# Cordova Bolt, Inc.

## Finished Hex Nut Product Information

### 1.0 Dimensions: As per ASME B18.2.2.

Nominal Size or Basic Major Diameter of Thread	F		C		T	
	Width Across Flats		Width Across Corners		Thickness	
	Max	Min	Max	Min	Max	Min
1/4	0.438	0.428	0.505	0.488	0.226	0.212
5/16	0.500	0.489	0.577	0.557	0.273	0.258
3/8	0.563	0.551	0.650	0.628	0.337	0.320
7/16	0.688	0.675	0.794	0.768	0.385	0.365
1/2	0.750	0.736	0.866	0.840	0.448	0.427
9/16	0.875	0.861	1.010	0.982	0.496	0.473
5/8	0.938	0.922	1.083	1.051	0.559	0.535
3/4	1.125	1.088	1.299	1.240	0.665	0.617
7/8	1.312	1.269	1.516	1.447	0.776	0.724
1	1.500	1.450	1.732	1.653	0.887	0.831
1-1/8	1.688	1.631	1.949	1.859	0.999	0.939
1-1/4	1.875	1.812	2.165	2.066	1.094	1.030
1-3/8	2.062	1.994	2.382	2.273	1.206	1.138
1-1/2	2.250	2.175	2.598	2.480	1.317	1.245
1-5/8	2.430	2.350	2.805	2.679	1.416	1.364
1-3/4	2.625	2.538	3.031	2.893	1.540	1.460
1-7/8	2.813	2.722	3.247	3.103	1.651	1.567
2	3.000	2.900	3.464	3.306	1.763	1.675
2-1/4	3.375	3.263	3.897	3.719	1.986	1.890
2-1/2	3.750	3.625	4.330	4.133	2.209	2.105
3	4.500	4.350	5.196	4.959	2.654	2.534

Disclaimer: The presented data is based off various industry standards. Cordova Bolt, Inc. strives to present up to date, accurate data. However Cordova Bolt, Inc. cannot be held liable for any errors or discrepancies within the presented information



**Cordova Bolt, Inc.**

5601 Dolly Avenue Buena Park CA 90621  
(714) 739-7500 - (714) 994-2661-fax  
www.cordovabolt.com



# Cordova Bolt, Inc.

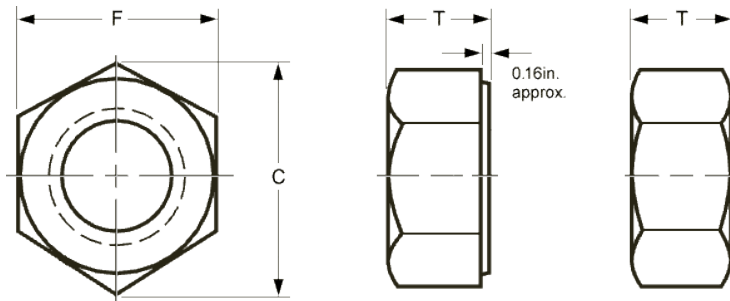

## 2.0 Mechanical Properties

### 2.1 Steel- SAE J995

Classification		Hardness	Proof Load Strength	
Grade	Nominal Size			
2	1/4" Through 1-1/2"	32 HRC Maximum	UNC and 8UN 90,000 PSI	UNF , 12 UN and Finer 80,000 Psi
5	1/4" Through 1-1/2"		32 HRC Maximum	1/4" through 1"
		UNC and 8UN 120,000 PSI		UNF, 12UN and Finer 109,000 PSI
		Over 1" though 1-1/2"		
		UNC and 8UN 105,000		UNF, 12UN and Finer 94,000
8	1/4" Through 1-1/2"	1/4" through 5/8": 24-32 HRC	All sizes and all thread pitches 150,000 PSI	
		Over 5/8" through 1": 26-34 HRC		
		Over 1" through 1-1/2": 26-36 HRC		

### 2.2 Stainless Steel- ASTM F594

Classification		Condition	Proof Load Strength KSI	Rockwell Hardness	Grade Marking
Type	Nominal Size				
304 (18-8)	1/4 to 5/8 incl	CW1	100 Minimum	B95 to C35	F594C
	3/4 to 1-1/2 incl	CW2	85 Minimum	B80 to C35	F954D
316	1/4 to 5/8 incl	CW1	100 Minimum	B95 to C35	F594G
	3/4 to 1-1/2 incl	CW2	85 Minimum	B80 to C35	F594H

Disclaimer: The presented data is based off various industry standards. Cordova Bolt, Inc. strives to present up to date, accurate data. However Cordova Bolt, Inc. cannot be held liable for any errors or discrepancies within the presented information



**Cordova Bolt, Inc.**

5601 Dolly Avenue Buena Park CA 90621  
(714) 739-7500 - (714) 994-2661-fax  
www.cordovabolt.com



# Cordova Bolt, Inc.

## 3.0 Surface Finish

Properties	Zinc	Zinc Yellow	Hot Dip Galvanized
Type	Trivalent (Cr+3)	Hexavalent (Cr+6) or Trivalent (Cr+3)	RoHS Compliant
Color	Clear	Yellow	
Minimum Coating Thickness	0.0001" / 3 Microns or 0.0002" / 5 Microns	0.0001 " /3 Microns or 0.0002" / 5 Microns	Sizes 3/8 " & Under : 0.0017" (43 microns). Sizes Over 3/8 " : 0.0020" (50 microns)
Specification	ASTM F1941 / F1941M. Fe/Zn 3AN or Fe/Zn 5AN. ASTM B633 SC1 Type III	ASTM F1941 / F1941M. Fe/Zn 3C or Fe/Zn 3CN or Fe/Zn 5C or Fe/Zn 5CN	ASTM F2329 / F2329M or ASTM A153/A153M

Disclaimer: The presented data is based off various industry standards. Cordova Bolt, Inc. strives to present up to date, accurate data. However Cordova Bolt, Inc. cannot be held liable for any errors or discrepancies within the presented information



**Cordova Bolt, Inc.**

5601 Dolly Avenue Buena Park CA 90621  
(714) 739-7500 - (714) 994-2661-fax  
www.cordovabolt.com